



12.1" Industrial Monitors
DuraVision®
FDX1201 / FDX1201T



Gray cabinet with or without touch panel



Black cabinet with or without touch panel

High brightness 12.1" monitors with PC and video inputs

Compact 12.1" Size

Composite (RCA)/S-Video

3D Y/C Separation Circuit

*NTSC signal

Underscan Display

1000 cd/m² Brightness Display

*Except panel mount and touch panel variations

White LED Backlight

5 Cabinet Variations

2-Year Warranty/24-Hour Use

12.1" Industrial Monitors

DuraVision®

FDX1201 / FDX1201T

	Cabinet Color	With Stand	Free Mount	Panel Mount IP65 Rated	Rack Mount	Chassis
Without Touch Panel	Gray	●	●	●	●	NA
	Black	●	●	●	●	
With Touch Panel	Gray	●	●	●	●	NA
	Black	●	●	●	●	

PC and Video Inputs

A D-Sub mini 15-pin (analog) input is included for connecting to PCs. Composite (RCA) and S-Video inputs which support NTSC, PAL, and SECAM are included for connecting to audio/visual equipment. For noise (flicker) reduction with NTSC signals, the composite and S-Video inputs have a 3-dimensional Y/C separation circuit that separates the video image brightness signal (Y signal) and color information signal (C signal).

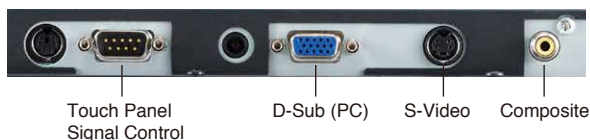

1000 cd/m² Maximum Brightness Display

With a maximum brightness of 1000 cd/m² for the DuraVision FDX1201 (except the panel mount variation) and 780 cd/m² for the DuraVision FDX1201T, the screen is highly visible even in bright ambient environments.

Available in Five Configurations

To accommodate the requirements of various installation environments, both models are available in five different configurations: standard (with stand), free mount (without stand), chassis, panel mount, and rack mount.

Underscan Display

These monitors offer both underscan and normal display settings. The underscan setting shows the entire image and is ideal for video. The normal setting displays about 95% of the image, which eliminates extraneous TV broadcasting data that sometimes appears at the edges of the screen.

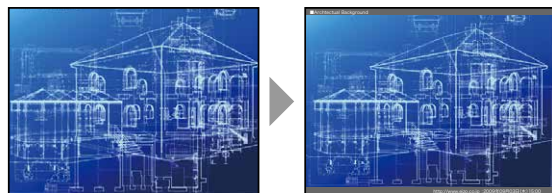

Normal (95%) Display

Underscan Display

Energy-Saving White LED

Both models employ a white LED backlight which offers a high brightness and limits power consumption compared to standard CCFL backlights. Even at the maximum brightness of 1000 cd/m² for the DuraVision FDX1201, maximum power consumption does not exceed 20 watts. Furthermore, the LED backlight is mercury free which minimizes its impact on the environment.

Durable Construction

The cabinets do not contain any ventilation holes and the perimeter of the control buttons are sealed, making these monitors impervious to liquids and dust. The panel mount versions are IP65-certified ensuring they can withstand dust ingress and are protected against low-pressure water jets.

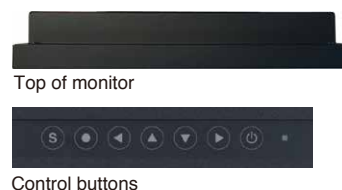

Top of monitor

Control buttons

Flexible Positioning

The monitors are built to operate in both standard horizontal positions and non-standard positions such as attached to a mounting device and tilted at an extreme angle. Furthermore, their internal circuitry is designed to withstand varying operating temperatures of different installation environments.

Crosshair Display

Crosshairs can be displayed on the screen for convenience when connected to a microscope. Both the thickness and color are adjustable.



- 2-year warranty that covers 24-hour use
- RoHS compliant
- Robust steel cabinet
- Two color variations



Gray

Black

Touch Screen LCD Monitor FDX1201T

- 10 million touches minimum
- Resistant to liquids and dust
- Also accepts touch input from a gloved hand

Touch Panel Specifications

Touch Panel Type	Analog resistive
Touch Life	10 million (min.)
Communication Protocol	RS-232C
Compatible OSes	Windows 7 (32-bit)* Windows Vista (32-bit) Windows XP (32-bit)

*Windows 7 (32-bit) driver downloadable from www.eizo.com.

Dimensions (mm)

With Stand

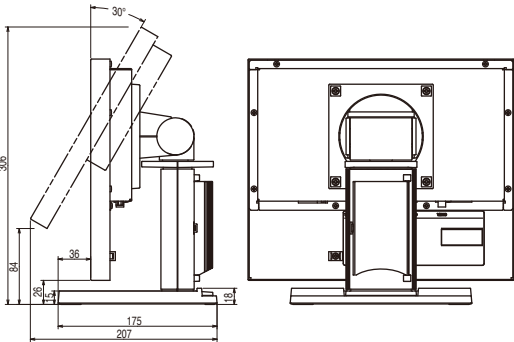
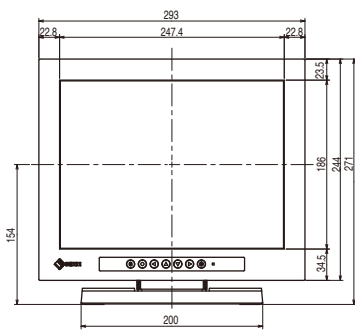
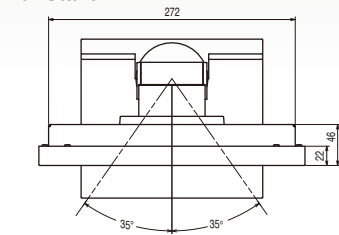

Model Name	With Stand	Free Mount	Panel Mount	Rack Mount	Chassis
FDX1201	4.1 kg	2.5 kg	2.8 kg	3.6 kg	2.2 kg
FDX1201T	4.4 kg	2.8 kg	3.1 kg	3.9 kg	2.5 kg
Hole spacing (VESA)	100 mm				
Operating temperature	0 – 50°C, 20 – 90% R.H. (No condensation)				

Free Mount

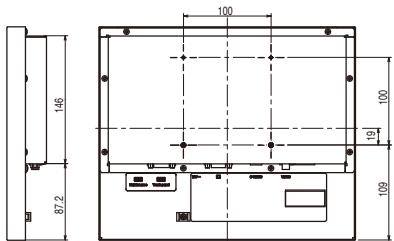

Panel Mount

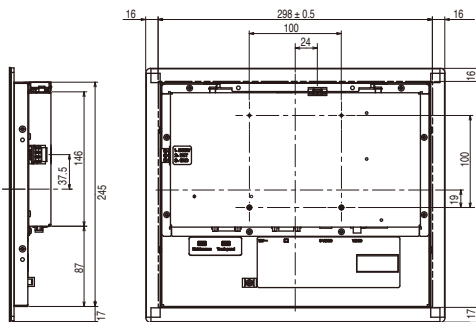
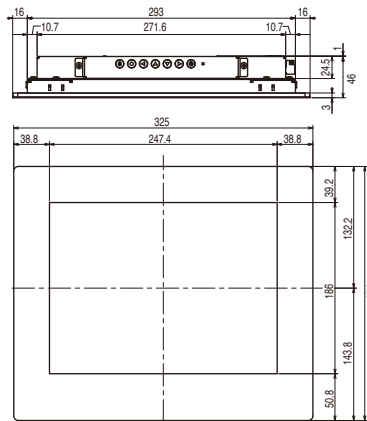
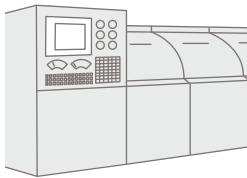

Rack Mount

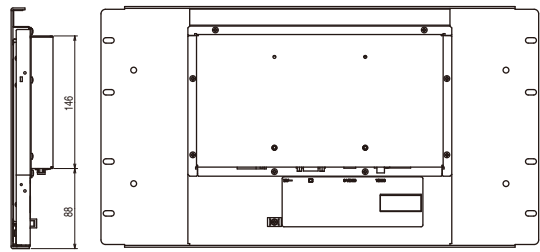
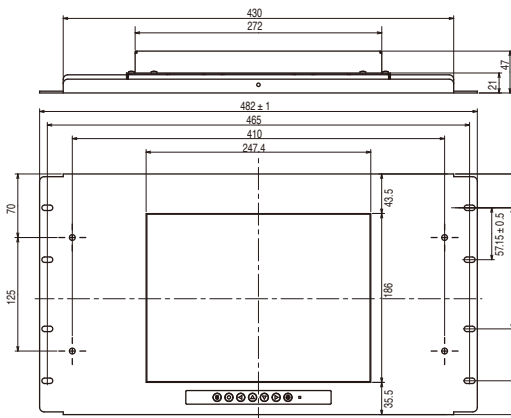
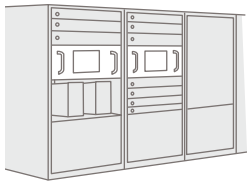

Chassis

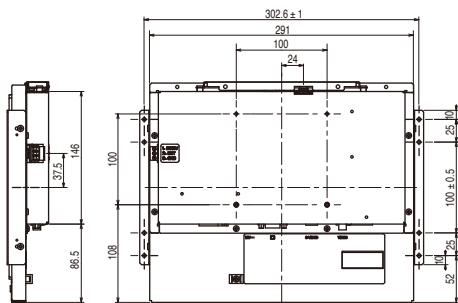
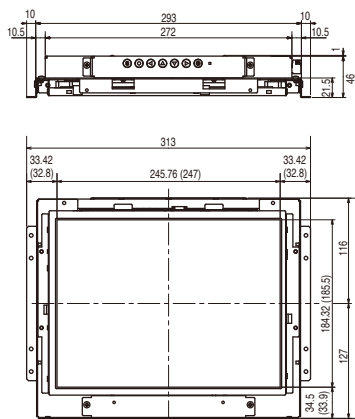

SPECIFICATIONS

	Without Touch Panel	With Touch Panel
	FDX1201	FDX1201T
Model Variations	With Stand, Without Stand, Chassis, Panel Mount, Rack Mount	With Stand, Without Stand, Chassis, Panel Mount, Rack Mount
Panel Size	12.1" / 31 cm (307 mm diagonal)	12.1" / 31 cm (307 mm diagonal)
Active Display Size (H × V)	245.8 × 184.3 mm	245.8 × 184.3 mm
Panel Type	TN	TN
Viewing Angles (H, V)	160°, 140° (at contrast ratio of 10:1)	160°, 140° (at contrast ratio of 10:1)
Brightness	1000 cd/m ²	780 cd/m ²
Contrast	600:1	600:1
Native Resolution	1024 × 768 (4:3 aspect ratio)	1024 × 768 (4:3 aspect ratio)
Pixel Pitch	0.240 × 0.240 mm	0.240 × 0.240 mm
Display Colors	16.7 million	16.7 million
Cabinet Colors	Gray, Black	Gray, Black
Dot Clock	Analog: 65 MHz	Analog: 65 MHz
Analog Scanning Frequency (H, V)	24 – 50 kHz, 55 – 75 Hz	24 – 50 kHz, 55 – 75 Hz
Video Input Terminals	PC: D-Sub mini 15 pin AV: Composite / S-Terminal	PC: D-Sub mini 15 pin AV: Composite / S-Terminal
Plug & Play	VESA DDC 2B	VESA DDC 2B
Power Requirements (Main Unit)	DC 12 V	DC 12 V
Power Consumption	17 W (maximum)	17 W (maximum)
Power Save Mode	Less than 0.8 W	Less than 0.8 W
Power Requirements (with AC adaptor)	AC 100 – 120 V / 200 – 240 V, 50 / 60 Hz	AC 100 – 120 V / 200 – 240 V, 50 / 60 Hz
Power Consumption	20 W (maximum)	20 W (maximum)
Power Save Mode	Less than 1.6 W	Less than 1.6 W
Tilt / Swivel / Pivot	30° Up / 35° Right, 35° Left	30° Up / 35° Right, 35° Left
Dimensions (W × H × D)	With Stand: 293 × 271 × 175 mm Free Mount: 293 × 244 × 46 mm Panel Mount: 325 × 276 × 46 mm Rack Mount: 482 × 265 × 47 mm Chassis: 313 × 243 × 46 mm	With Stand: 293 × 271 × 175 mm Free Mount: 293 × 244 × 46 mm Panel Mount: 325 × 276 × 46 mm Rack Mount: 482 × 265 × 47 mm Chassis: 313 × 243 × 46 mm
Net Weight	With Stand: 4.1 kg Free Mount: 2.5 kg Panel Mount: 2.8 kg Rack Mount: 3.6 kg Chassis: 2.2 kg	With Stand: 4.4 kg Free Mount: 2.8 kg Panel Mount: 3.1 kg Rack Mount: 3.9 kg Chassis: 2.5 kg
Color Adjustment	PC: Brightness, Contrast, Black Level, PC Settings (Clock, Phase, Position, Range Adjustment, Color Mode [R/G/B], Reset) AV: Brightness, Contrast, Black Level, Sharpness, Saturation, Hue	PC: Brightness, Contrast, Black Level, PC Settings (Clock, Phase, Position, Range Adjustment, Color Mode [R/G/B], Reset) AV: Brightness, Contrast, Black Level, Sharpness, Saturation, Hue
Other Settings	Video Aspect (Video input only), Power Save, Reverse, Cursor [Color/Width], Beep, Language, Touch Panel, Information	Video Aspect (Video input only), Power Save, Reverse, Cursor [Color/Width], Beep, Language, Touch Panel, Information
Certifications and Standards (Stand and free mount models only)	c-Tick, CE, CB, FCC-B, VCCI-B, RoHS, WEEE	c-Tick, CE, CB, FCC-B, VCCI-B, RoHS, WEEE
Supplied Accessories	AC adaptor, PDF user's manual with warranty card, clamper, 4 screws for mount option	AC adaptor, PDF user's manual with warranty card, touch panel cable (RS-232C), CD-ROM (touch panel driver), clamper, 4 screws for mount option
Warranty	Two Years	Two Years

Touch Panel

Touch Panel Type	–	Analog resistive
Touch Life	–	10 million touches (minimum)
Compatible OS	–	Windows 7 32-bit Windows Vista 32-bit Windows XP 32-bit
Communication Protocol	–	RS-232C

Panel mount version installation requirements

Applicable to level installations only.

Panel aperture dimensions

(Unit: mm)

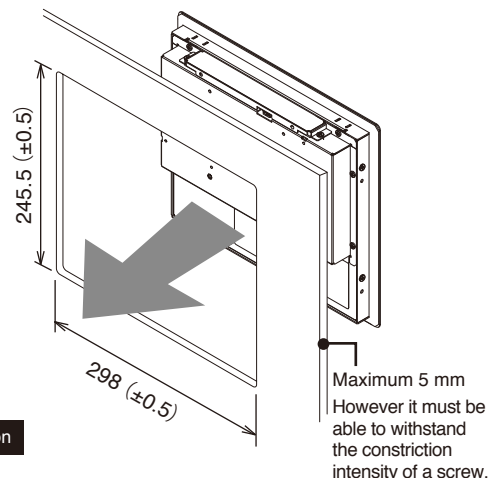

Panel Installation

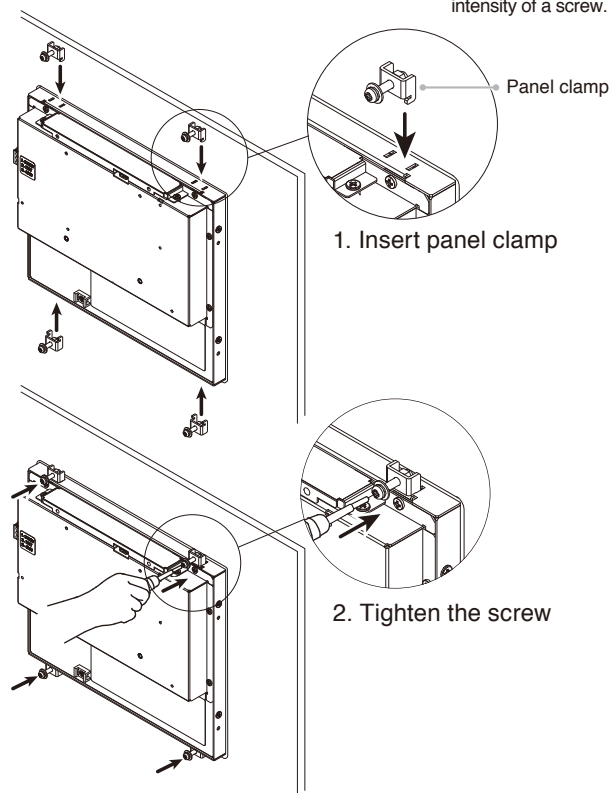

EIZO Corporation

153 Shimokashiwano, Hakusan, Ishikawa 924-8566 Japan

Phone +81-76-277-6792 Fax +81-76-277-6793

www.eizo.com

All product names are trademarks or registered trademarks of their respective companies. DuraVision and EIZO are registered trademarks of EIZO Corporation. Specifications are subject to change without notice.

Copyright© 2010 EIZO Corporation. All rights reserved.