



FlexScan® S2111W
FlexScan® S2411W

FlexScan Widescreen Monitors



Ready for action ...



... ready for enjoyment.

EIZO ensures a brilliant performance.

If your passion is creating, manipulating or simply enjoying movies or photos, the FlexScan S2411W and S2111W are monitors made with you in mind. Utilizing EIZO's new OutlineEnhancer and ContrastEnhancer technologies developed for high-quality TVs, and featuring fast response time and high brightness, these 24.1" and 21.1" monitors provide a remarkably richer viewing experience. Touch-sensitive switches on the front panel and an easy-to-position stand make them convenient to use as well. Whether you're a movie maker or a movie buff, a graphic artist or music composer, you'll be inspired by the brilliant performance of these FlexScan monitors.

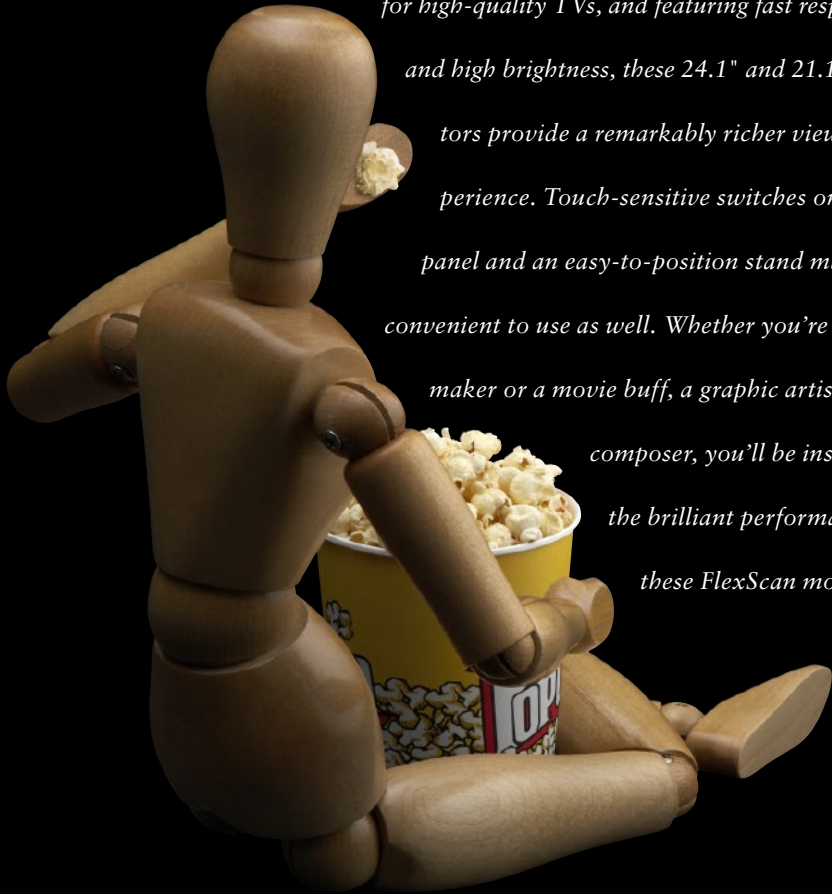

Widescreen Format

Both monitors employ a 16:10 aspect ratio as opposed to the 4:3 ratio of conventional screens. This increased horizontal space means you can keep tool palettes open without covering the window you're working on. And because the 16:10 aspect ratio is almost the same as the 16:9 of many widescreen DVDs, you can enjoy movies with minimal black borders at the top and bottom of the screen.

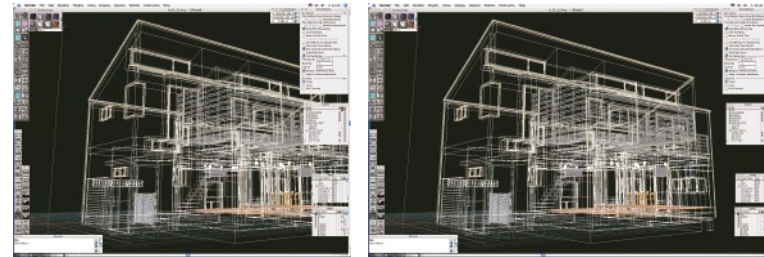

Conventional monitor: working space and tool palettes overlap.

Widescreen monitor: full working space and tool palettes are displayed simultaneously with no overlap.

ContrastEnhancer Boosts Dynamic Contrast to 3000:1

Both models include a ContrastEnhancer function, which is built into EIZO's powerful new ASIC (Application Specific IC). Originally developed for EIZO's LCD TVs*, it adjusts brightness, gain, and gamma for images that are too light or too dark to their ideal levels. With moving images it produces a dynamic contrast ratio of 3000:1, resulting in deeper blacks and more lifelike images.

*EIZO LCD TVs are available only in Japan.

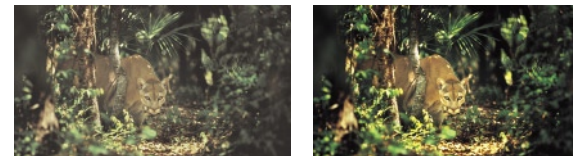

ContrastEnhancer off

ContrastEnhancer on

OutlineEnhancer for Sharper Images

The ASIC also includes an OutlineEnhancer, which sharpens any blurred areas in an image. Because the filtering is done inside the monitor rather than by PC software, the OutlineEnhancer is effective

for both still and moving images. Seven degrees of adjustment from soft to sharp are provided.



OutlineEnhancer off



OutlineEnhancer on

Fast Response Time

To ensure that movies and other moving images look clean and sharp, with an absolute minimum of blurring and ghosting, both monitors include an overdrive circuit. Commonly used in LCD TVs, overdrive improves the time required to transmit gray levels to 6 ms for the S2411W and 8 ms for the S2111W.



Without overdrive circuit



With overdrive circuit

450 cd/m² Brightness

With high brightness of 450 cd/m², the same as high quality LCD TVs, these monitors present a clear view even in bright environments. This performance is made possible by a direct backlighting system, which also provides higher power efficiency and better uniformity.

High Definition Digital Signal Support

The FlexScan S2411W supports 1080p high definition digital signal at the actual screen resolution of 1920 × 1080 (16:9 aspect ratio). (Black borders are displayed on the top and bottom of the screen.)

Color Vision Deficiency Simulation

To accommodate people with red-green color vision deficiency (protanopia and deuteranopia), care must be taken in choosing color

schemes for things like maps, signage, indicator lights, etc. The FlexScan S2411W instantly simulates how still and moving images appear to people with color vision deficiency, and does so much faster than software-based tools that slow down with larger files.



Original mode



Protanope mode



Deuteranope mode

While the S2411W simulation is very close, it is not exact — people with color vision deficiency are more sensitive to differing levels of luminance and saturation than those with normal color vision, so some unavoidable perceptual differences will remain. Switching between simulation modes is done with the bundled UniColor Pro software which is currently compatible with Windows XP/2000 only.

14-Bit Processing

The EIZO-developed ASIC used in both monitors features 14-bit color processing capability. This allows a larger number of grayscale increments, for smooth grayscale rendering. The result is a much greater degree of color detail, especially in dark areas and shadows.

Fine Contrast Mode Selection

For optimum viewing of all types of content, the Fine Contrast function allows the selection of five imaging modes: Text, Picture, Movie, Custom, and sRGB. You can navigate between the modes by pressing a button, or assign a mode to any application with the bundled ScreenManager[®] Pro for LCD utility software so that when the application is opened, the screen automatically changes to its assigned mode.

Detailed Color Control

Gamma, saturation, hue, gain, and color temperature from 4,000 K to 10,000 K can all be adjusted for accurate, display of color. For fine-tuning of even a single color, the hue and saturation settings for RGB and CMY can be adjusted independently.

ArcSwing 2 Stand



This innovative stand offers a curved range of movement so you can position it at eye level or at a low angle akin to reading a book. In addition, it features a sturdy base and a compartment for cable management.

Touch Sensitive Switches

Sensitive electrostatic “touch” switches on the front panel present a sophisticated appearance and are easier to engage than the small buttons of most LCD monitors.

Dual DVI-I Inputs

The two DVI-I input terminals can accept both digital and analog inputs for greater freedom in connecting other equipment. If both types are connected, you can switch between them via a front panel button.

USB 2.0 Hub

Both monitors provide a high speed (480 Mb/s) USB 2.0 hub with two downstream ports which are conveniently located on the side of the monitor for quick connection of peripherals.

Accessories

Accessories also available include mounting arms, panel protectors, monitor hoods, and client management software. For detailed information, please see www.eizo.com/products/accessories/

Customer Assurance

Both models come with a five-year warranty, comply with leading industry standards including TCO'03 and TÜV Ergonomics, and carry the EIZO Eco Products 2006 label indicating they meet strict internal requirements for design, manufacturing, etc. The S2111W is TCO'06 Media Displays certified, and the S2411W is certified by the Color Universal Design Organization of Tokyo, Japan.



S2111W

S2411W



FlexScan S2411W



FlexScan S2111W

Panel	Size and Type	61 cm (24.1") TFT color LCD panel	53 cm (21.1") TFT color LCD panel
	Viewing Angles (H, V)	178°, 178° (at contrast ratio of 10:1)	178°, 178° (at contrast ratio of 10:1)
	Brightness / Contrast	450 cd/m ² / 1000:1 (3000:1 dynamic contrast)	450 cd/m ² / 1000:1 (3000:1 dynamic contrast)
	On/Off Response Time	16 ms (typical)	16 ms (typical)
	Midtone Response Time¹	6 ms	8 ms
	Native Resolution	1920 × 1200	1680 × 1050
	Active Display Size (H × V)	518.4 × 324 mm	453.6 × 283.5 mm
	Viewable Image Size	Diagonal: 611 mm	Diagonal: 534 mm
	Pixel Pitch	0.270 × 0.270 mm	0.270 × 0.270 mm
	Display Colors	16.77 million from a palette of 1.06 billion	16.77 million from a palette of 1.06 billion
Available Cabinet Colors		White, Black	White, Black
Dot Clock		Analog: 202.5 MHz, Digital: 162 MHz	Analog: 150 MHz, Digital: 120 MHz
Scanning Frequency (H, V)		Analog: 24 – 94 kHz, 49 – 86 Hz Digital: 31 – 76 kHz, 59 – 61 Hz (VGA Text: 69 – 71 Hz)	Analog: 24 – 82 kHz, 49 – 86 Hz Digital: 31 – 65 kHz, 59 – 61 Hz (VGA Text: 69 – 71 Hz)
Input Signals		Analog: RGB Analog, Digital: DVI Standard 1.0	
Input Terminals		DVI-I 29 pin × 2 (switchable)	
USB Ports / Standard		1 upstream, 2 downstream / USB Standard Rev. 2.0	
Power	Power Requirements	AC 100 – 120 V, 200 – 240 V: 50 / 60 Hz	
	Power Consumption	110 W (maximum)	
	Power Save Mode	Less than 2 W	
Physical Specifications	Height Adjustment Range	95 mm	
	Tilt / Swivel / Pivot	60° Up, 5° Down / 172° Right, 172° Left / –	
	Dimensions (W × H × D)	With Stand: 566 × 358.7 – 480 × 230 mm Without Stand: 566 × 396 × 85 mm	With Stand: 501 × 341.1 – 459.5 × 230 mm Without Stand: 501 × 355 × 85 mm
	Net Weight	With Stand: 10.2 kg, Without Stand: 7.8 kg	With Stand: 8.2 kg, Without Stand: 5.8 kg
Display Mode Options		Fine Contrast (Text, Picture, Movie, sRGB, Custom, WindowMovie ²), Auto Fine Contrast ³	
ScreenManager OSD Adjustment Functions	Screen Adjustment	Clock, Phase, Position, Resolution, Range, Signal Filter, Screen Size (full screen, enlarge, normal), Smoothing (5 stages), Border Intensity	
	Color Adjustment	Brightness, Independent 6-Color Control, Gamma, Temperature (in 500 K increments from 4,000 K – 10,000 K), Saturation, Hue, Gain, Reset	
	Power Save Settings	Analog: PowerManager (VESA DPMS), Off Timer, Digital: PowerManager (DVI DMPM), Off Timer	
	Other Settings	Signal Settings, Input Priority, Product Information (product name, serial number, resolution, operating time), OSD Menu Settings, Adjustment Lock, Languages (English, French, German, Italian, Japanese, Simplified Chinese, Spanish, Swedish, Traditional Chinese), Reset, Enhancer (Contrast, Outline)	
Certifications and Standards		TCO'06 (S2111W only), TCO'03, TÜV/Ergonomics (including ISO 13406-2), TÜV/GS, c-Tick, CE, CB, UL (cTÜVus), CSA (cTÜVus), FCC-B, Canadian ICES-003-B, TÜV/S, VCCI-B, EPA ENERGY STAR®, EIZO Eco Products 2006	
Warranty		Five Years ⁴	

¹ Average response time measured between each grayscale level of 31, 63, 95, 127, 159, 191, and 223. ² WindowMovie mode is selectable only when Auto Fine Contrast is active. ³ Bundled ScreenManager Pro for LCD is necessary to activate Auto Fine Contrast. Support for this function varies with the graphics board used. ScreenManager Pro for LCD is compatible with the Microsoft® Windows® 98SE/Me/2000/XP operating systems only. ⁴ The usage time is limited to 30,000 hours or less, and the warranty period of the LCD panel and backlight is limited to three years from the date of purchase. With current LCD technology, a panel may contain a limited number of missing or flickering pixels.